

'L' OVERALL LENGTH	'B' BASE DIAMETER	WEIGHT IN LBS.
10'-0"	20"	76
12'-0"	19 11/16"	87
14'-0"	19 3/4"	99
15'-0"	19 3/4"	104
16'-0"	19 3/4"	110
18'-0"	20"	125
20'-0"	20"	131
22'-0"	19 15/16"	145
24'-0"	20"	156

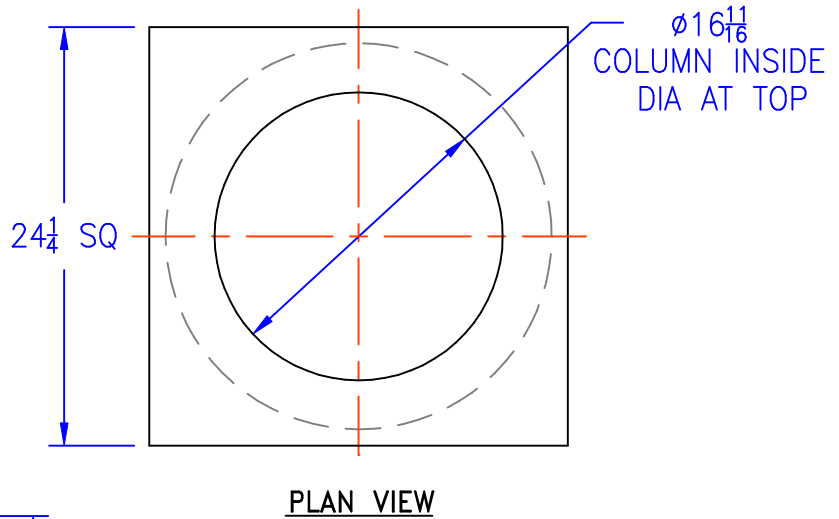

20" COLUMN SPECIFICATIONS:

WALL THICKNESS: .125 (1/8")
 LOAD BEARING CAPACITY: 26,000 LBS (AXIALLY)
 NECK DIAMETER: 17 INCHES
 TOP (BUILD-UP) DIA: 17 3/4 INCHES

20" DIAMETER COLUMN - TUSCAN

DATE	REV	CONTRACT NUMBER		Arch Net Building Products, Inc. Tel: 888.483.2724 Fax: 402.483.0535 website: www.archcolumns.com	
UNLESS OTHERWISE SPECIFIED DIMENSIONS ARE IN INCHES		ORIGINATOR		DATE	
TOLERANCES		T. HARTLEY		11/11/04	
DECIMAL	ANGULAR	CHECKER		PROJECT ENGINEER	
.X ±.1	±.5°			MANUFACTURING ENGINEER	
.XX ±.06	FRACTION			PROGRAM MANAGEMENT	
.XXX ±.030	±1/8"			SIMILAR TO	
DO NOT SCALE DRAWING		ACT WT		CALC WT	
		N/A		N/A	
DESCRIPTION		TITLE		SIZE	
REVISIONS		FIBERGLASS COLUMN DETAIL		A	
		20" DIAMETER		DRAWING NUMBER	
		TUSCAN CAP & BASE		REV	
		SCALE		RELEASE DATE	
		NONE		SHEET 1 OF	